

Part of the *Creekside Range*

the palms



don't miss a reel bargain...

INCLUSIONS:

- Floor Coverings
- Verticals
- Turf Landscaping
- Fencing
- Driveway & Pathway
- Gas Hotwater
- All siteworks & Engineering
- Rainwater Tank

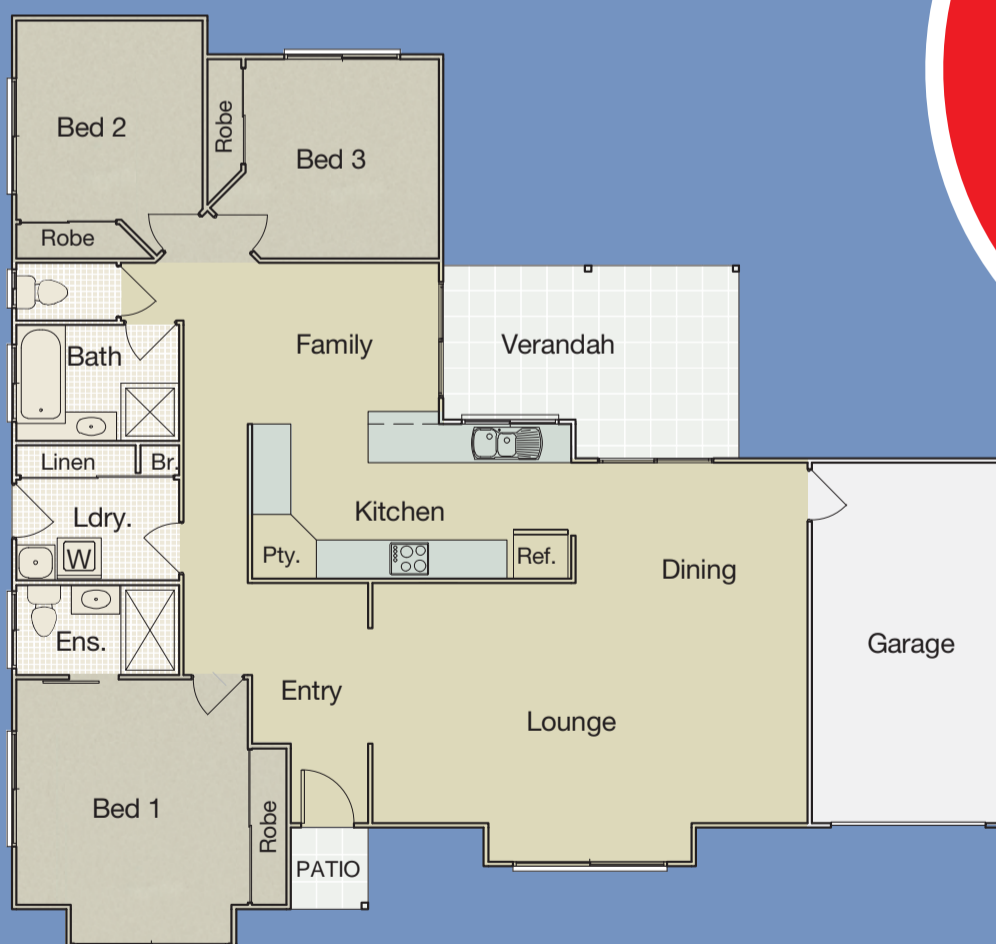

House & Land
starting from
\$305,000*

GARAGE 3000 X 5600
BED 1 3600 X 4100
BED 2 2900 X 3100
BED 3 3000 X 3100
FAMILY - 3970 X 2400
LOUNGE - 4330 X 6760

Whilst every care has been taken in the preparation of this document it is for guidance only. No warranty of its reliability or accuracy is given by the Developer or its agent/s. Intending purchasers should satisfy themselves by inspection or otherwise to the correctness of each description or reference. All images are indicative only. Availabilities of lots subject to change. All dimensions are approximate only. *Terms and conditions apply, prices correct at time of printing.



cooloola sands

YOUR SEACHANGE
on the Noosa Fraser Coast

Part of the *Creekside Range*

Contact Us Today!

Phone: 1300 735 045

www.cooloolasands.com.au